

Town and Country Planning Act 1990
The Borough of Charnwood (88 Main Street, Newtown Linford) Tree
Preservation Order 2023

The Charnwood Borough Council, in exercise of the powers conferred on them by section 198 of the Town and Country Planning Act 1990 make the following Order:

Citation

1. This Order may be cited as The Borough of Charnwood (88 Main Street, Newtown Linford) Tree Preservation Order 2023.

Interpretation

2. (1) In this Order “the authority” means the Charnwood Borough Council.
(2) In this Order any reference to a numbered section is a reference to the section so numbered in the Town and Country Planning Act 1990 and any reference to a numbered regulation is a reference to the regulation so numbered in the Town and Country Planning (Tree Preservation)(England) Regulations 2012.

Effect

3. (1) Subject to article 4, this Order takes effect provisionally on the date on which it is made.
(2) Without prejudice to subsection (7) of section 198 (power to make tree preservation orders) or subsection (1) of section 200 (tree preservation orders: Forestry Commissioners) and, subject to the exceptions in regulation 14, no person shall:
 - (a) cut down, top, lop, uproot, wilfully damage, or wilfully destroy; or
 - (b) cause or permit the cutting down, topping, lopping, wilful damage or wilful destruction of,

any tree specified in the Schedule to this Order except with the written consent of the authority in accordance with regulations 16 and

17, or of the Secretary of State in accordance with regulation 23, and, where such consent is given subject to conditions, in accordance with those conditions.

Application to trees to be planted pursuant to a condition

4. In relation to any tree identified in the first column of the Schedule by the letter "C", being a tree to be planted pursuant to a condition imposed under paragraph (a) of section 197 (planning permission to include appropriate provision for preservation and planting of trees), this Order takes effect as from the time when the tree is planted.

Dated this 14th day of April 2023

The Common Seal of the Charnwood Borough Council
was affixed to this Order in the presence of:



A handwritten signature in black ink, consisting of several loops and a long horizontal stroke.

.....

2023/24 - 5

SPECIFICATION OF TREES

Trees specified individually (encircled in black on the map)

Reference on map	Description	Situation
T1	Yew	Frontage approx. SK451618 310280
T2	Spruce	Rear garden southern boundary approx. SK451501 310280

Trees specified by reference to an area (within a dotted black line on the map)

Reference on map	Description	Situation
	None	

Groups of trees (within a broken line on the map)

Reference on map	Description (including number of trees in the group)	Situation
G1	Fir	Southern boundary approx. SK451612 310283
G2	Leylandii	Southern boundary approx. SK451601 310284

Woodlands (within a continuous black line on the map)

Reference on map	Description	Situation
	None	

I certify this map shows the tree referred to in the first schedule of the Borough of Charnwood (88 Main Street, Newtown Linford) Tree Preservation Order 2023



Authorised signatory

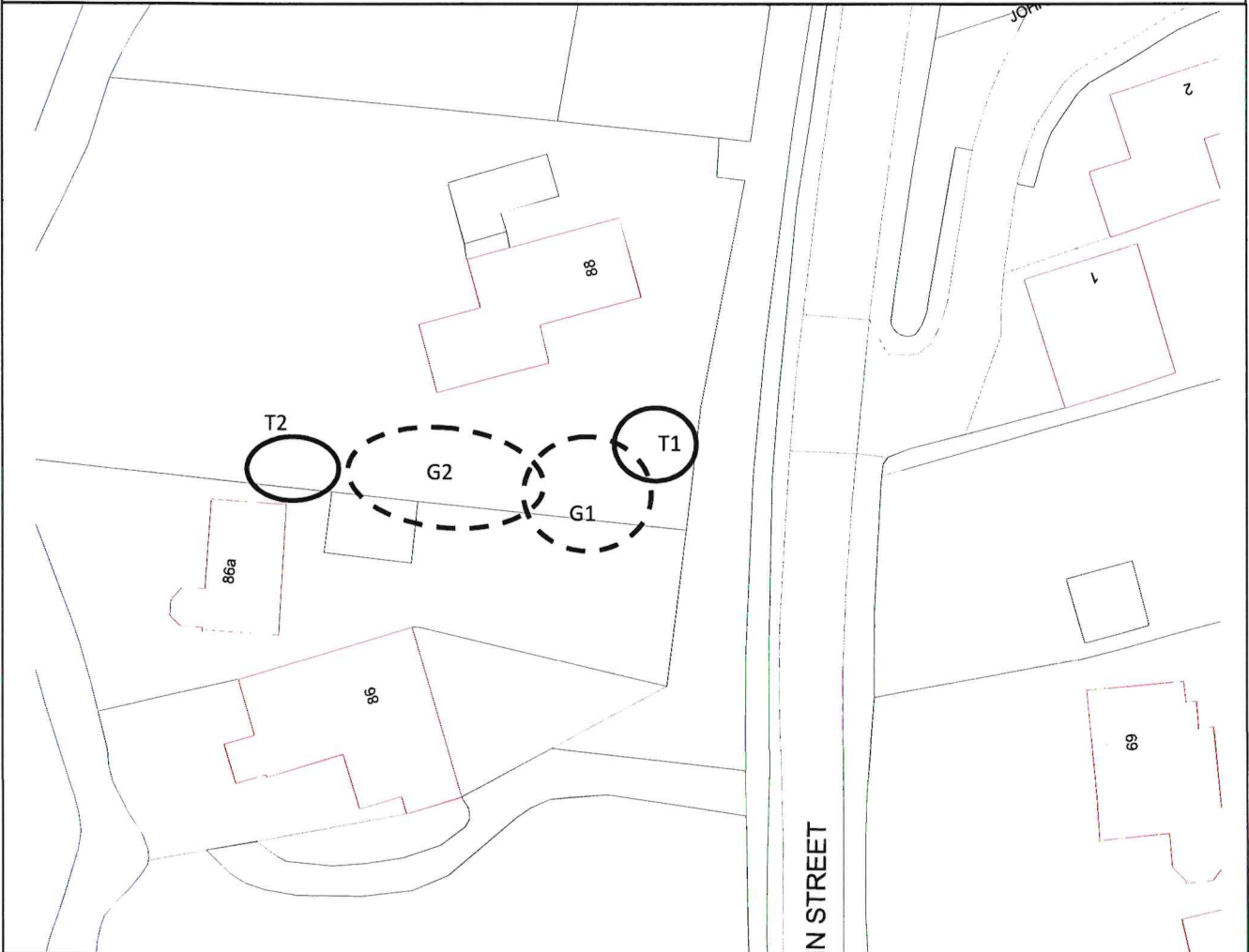

Borough of Charnwood
(88 Main Street, Newtown Linford)
Tree Preservation Order 2023

R Bennett Dip. TP. MRTPI
Head of Planning & Growth
Borough of Charnwood
Southfields
Loughborough
Leics. LE11 2TN
Date: 4 April 2023
Scale: 1:1250
Prep: NO'D



2023/24-5